

PTC® Live Global

CUST 212 - Little Known Tips & Tricks

Justin Roegner
Senior IT Engineer – CAD/PDM



Agenda

PTC® Live
Global

- Sketcher
- Part
- Assembly
- Drawing
- PTC Windchill



Sketcher

Alter Pasted Center

Sketcher

- Hold Alt and click the entity where you want the snap origin
- Snapping doesn't always create constraints

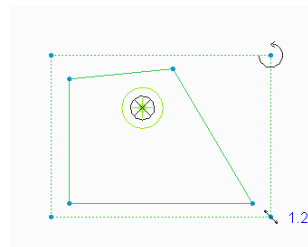
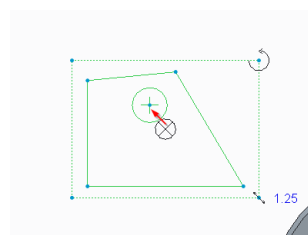

Sketcher

- The circle is divided into quadrants
- Quadrant represents tangent or 3 point arc creation
- Exiting tangent the entity will create a tangent arc
- Exiting non-tangent will create a 3 point arc
- Returning the cursor to the circle resets the arc type



Part

- Imports can be replaced
- Imports have a reference pairing option
 - Old Reference/New Reference
- Replaced references work downstream
- Use Reference pairing to prevent failures
 - Show Pairs without Local Children for all missing references
 - ! Is not matched
 - Is Automatched
 - Is manually matched

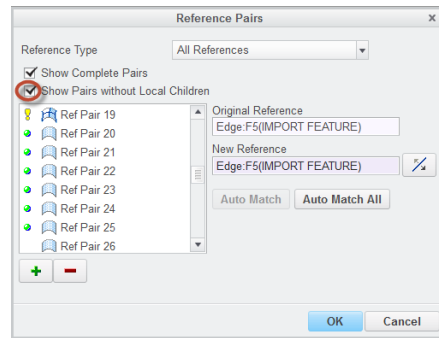

7

Part

- Use a simplified representations when another option is possible for the same part number
- First exclude features (suppress)
- Then create cuts
- Creating cuts first can result in failure if references are suppressed

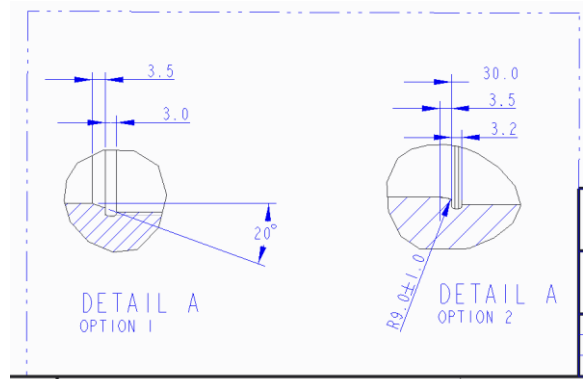

8

Part

- Merge “flat” decal into new model
- Wrap using “Toroidal Bend”
- Sketch is the “revolved” profile
- Geometry coordinate system is where the radius value is measured from
- Radius is distance from “X” axis

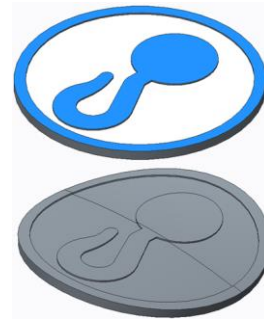

Part

- Sketch plane can be anywhere
- Set depth reference for both sides

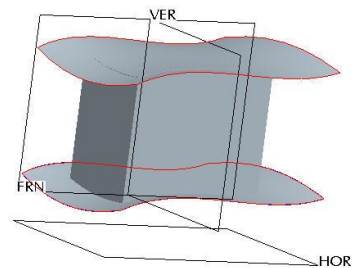

Part

- Solidify will accept a plane as a cutting reference

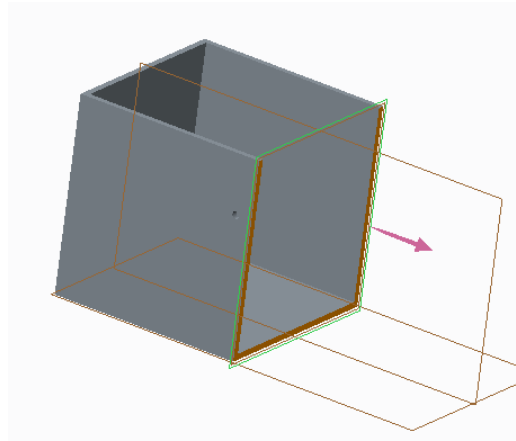

11

Part

- Offset by dimension
- or
- Offset to datum plane

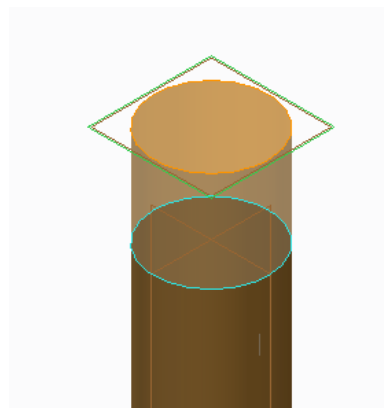

12

Part

- Create datum plane in the feature
- Set depth "To Selected"

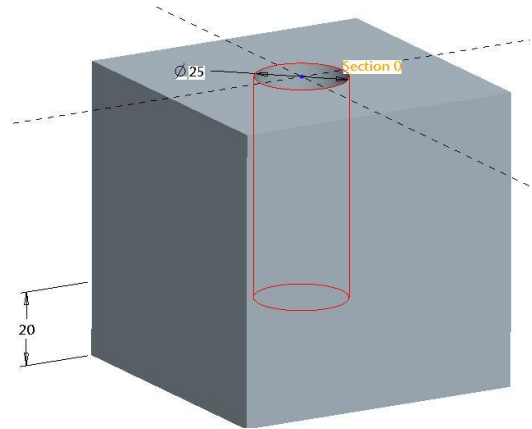

13

Assembly

14

Multiple Positions w/o a Family Table

Assembly

- Family tables are for different components
 - Not for different positions
- Assemble using appropriate mechanism constraints
- Create a snapshot
- Make it available in Drawing Mode if necessary (Creates an exploded view for drawing mode)

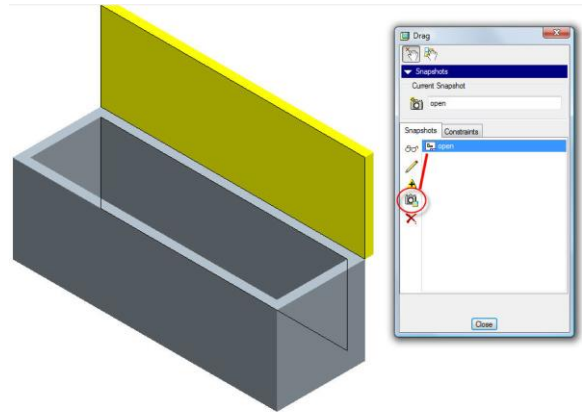

15

Temporary Constraints

Assembly

- Add constraints
- Take snapshot

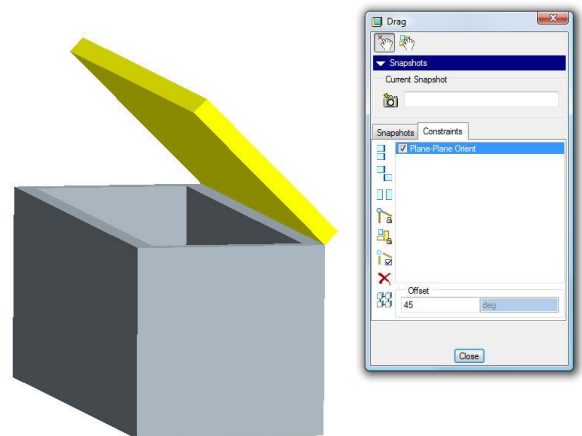

16

Assembly

- **All components get 6 DOF constraints**
 - 1st component could be default

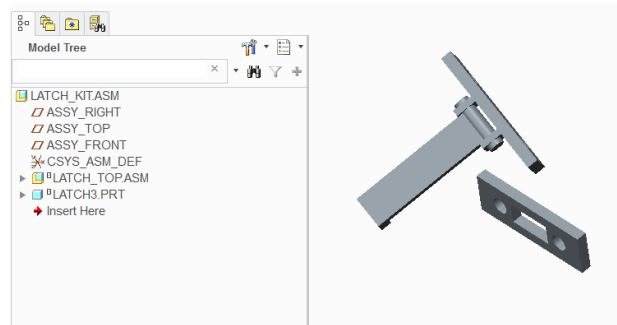

17

Assembly

- **Must assemble kit twice**
 - Assemble by simply clicking “ok” to leave the kits packaged
- **Click the drag components button**
 - Internally clicking the drag components instantiates the kits because there are 2+
- **Delete the second kit**
 - Instantiated kit remains instantiated
- **Edit definition of the kit**
 - Each component is its own “General” set (or Rigid?)

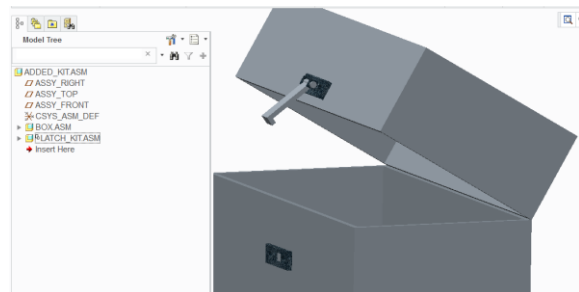

18

Drawing

Match Drawing Layers to Current Model Layers

Drawing

- When drawing layers are independent of model
- Will copy the same status used in the model

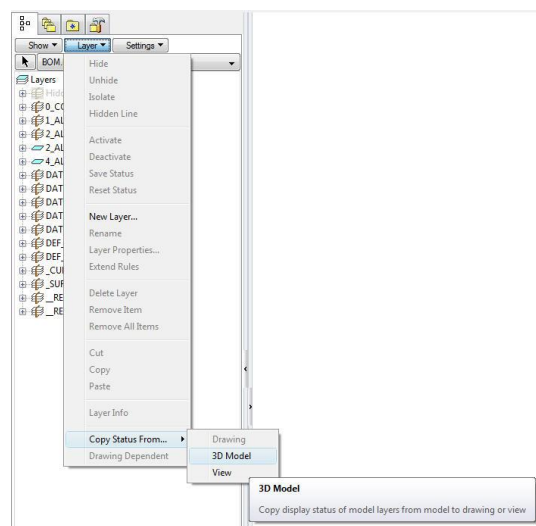

Override Drawing "Auto Filter"

Drawing

- Used to set what YOU want filtered
- No need to hold the "Alt" override key
- Can be set as your default

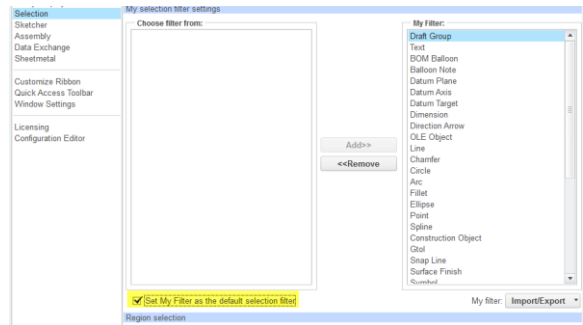

21

Reset Erased Dimensions

Drawing

- Deletes erased dimensions on retrieve
- Dimensions will appear when annotations are shown

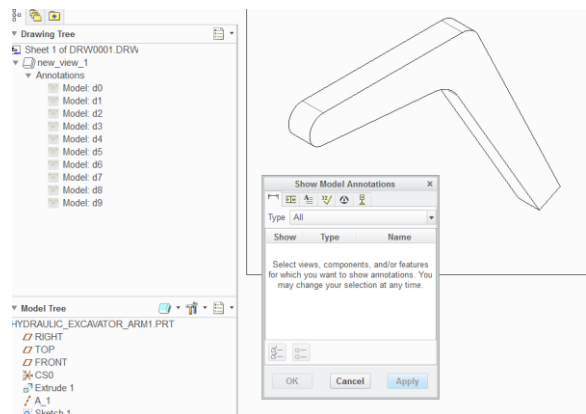

Config.sup only
enable_auto_drawing_update yes
auto_drawing_update_command delete_erased_axes
auto_drawing_update_command delete_erased_dimensions

22

PTC Windchill

Separate a family table

PTC Windchill

- Open the instance
- Open the generic
- Remove the instance from the family table
- Save the generic
- All assemblies update unless the component was replaced through a family table

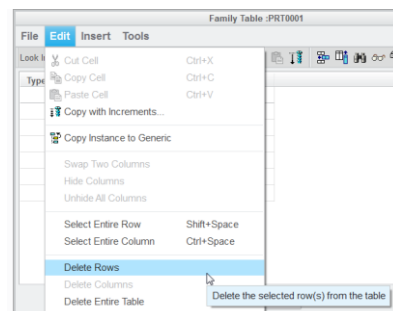

PTC Windchill

- “Remember These Components” will create a dummy reference
- This can be prevented by either unchecking the option or defaulting the setting off

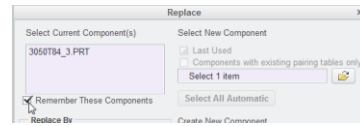

`remember_replaced_components no`

Remove the Ghosts From Model

PTC Windchill

- All “Dummy” references can be removed
- An “Independent” reference will be restored upon editing definition

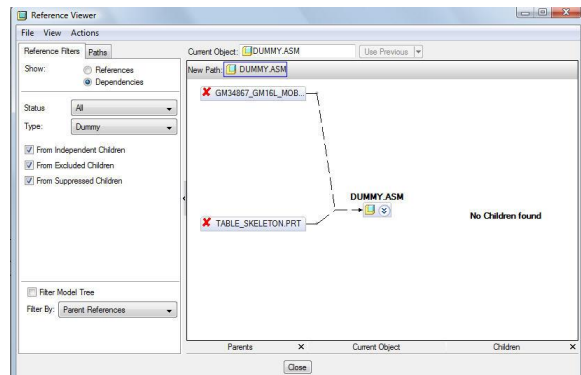

Cleanup Drawing Ghosts

PTC Windchill

- Add the config options
- Save the drawing locally
 - Make sure only .drw resides in folder
- Erase memory
- Open the drawing from the local drive
- Click Remove
- Save drawing overwriting the PTC Windchill copy
- Remove the config options or reset them

`cleanup_drawing_dependencies=yes_cs_not_required`
`cleanup_layout_dependencies=yes_cs_not_required`

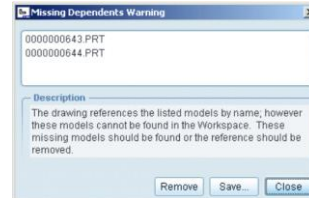

Overwrite existing file

PTC Windchill

- Make change and save
- Search PTC Windchill for that file name
- Check out
 - Make sure "Reuse" is selected
- Revising to an "editable" state is also possible
 - Make sure "Reuse" is selected
- Use Advanced tab for a visual indicator of what is happening

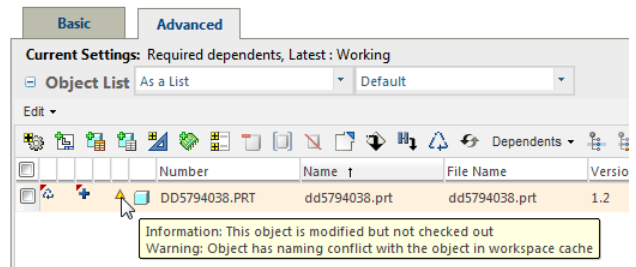
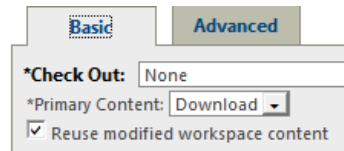

- Your feedback is valuable
- Don't miss out on the chance to provide your feedback
- Gain a chance to win an instant price!
- Complete your session evaluation now

PTC® Live Global