

MARK:  
PART NUMBER  
REVISION LEVEL  
SUPPLIER ID

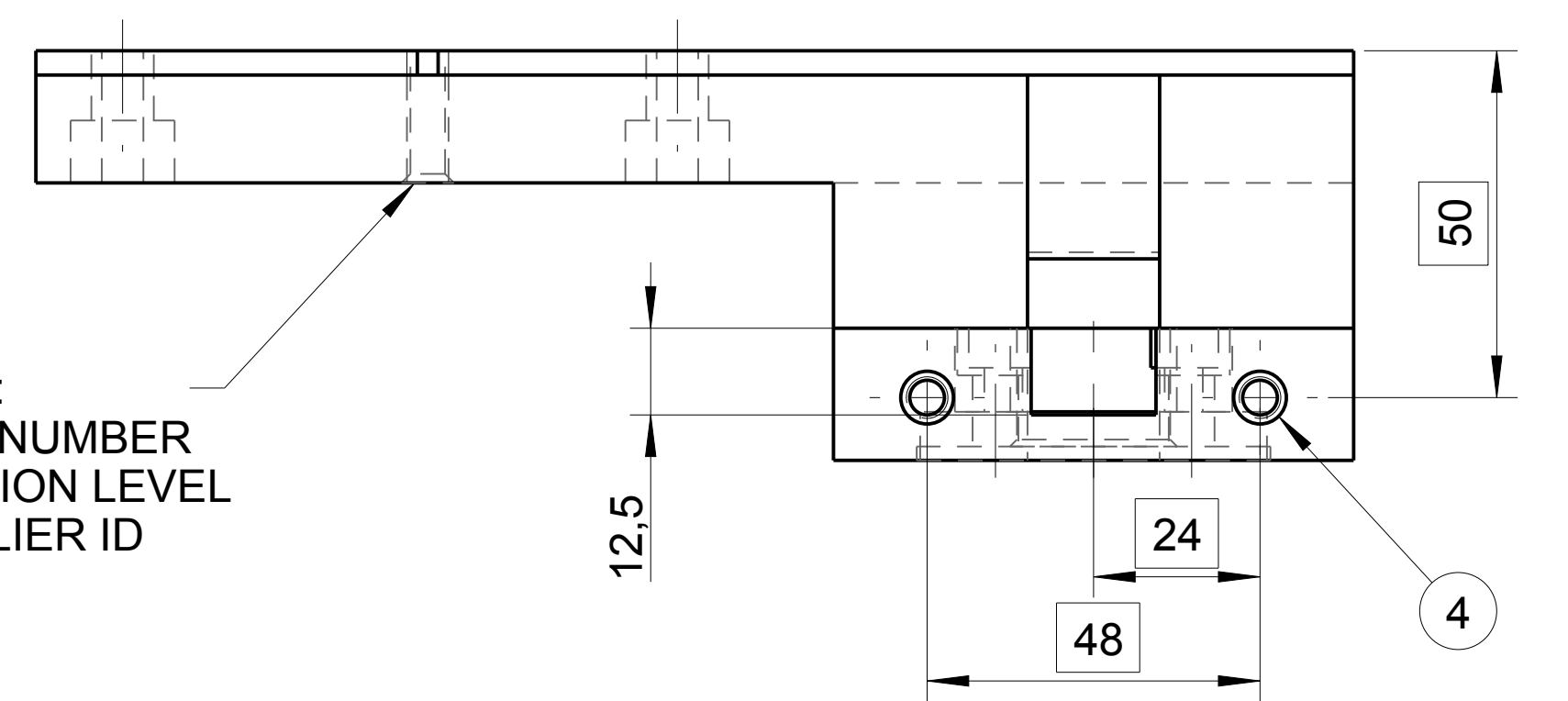

ITEM Pos.	QTY Stck	PART NAME BENENNUNG	MATERIAL SIZE Rohmabe	MATERIAL Werkstoff
A	1	DETAIL 1	22 X 100 X 190	1018
B	1	DETAIL 2	19,05 X 75 X 252	1018
C	1	DETAIL 3	19,05 X 40 X 120	1018
D	1	DETAIL 4	19,05 X 40 X 75	1018
E	1	DETAIL 5	19,05 X 40 X 52	1018

HOLEGRID BOHRUNG	INTER SECT / ABSCH NITT	DESCRIPTION BESHREIBUNG-AT ASSEMBLY	
1		3X 9;9,22 THRU; 15-15,27 9	$\oplus \parallel 0,5$ A B C
2		2X 5;5-5,68 THRU; 10-10,27 5,7	$\oplus \parallel 0,25$ A B C
3		4X 6;6-6,82 THRU; 11-11,27 6,8	$\oplus \parallel 0,3$ A B C
4		2X 5;26,9; 7,6X90°; M6X1-6H PLUG TAP 13,5	$\oplus \parallel 0,3$ A B C
5		2X 5;5 THRU; *5,9 MACHINE REAM;*6 FIN; HAND REAM FOR <=>	$\oplus \parallel 1$ A B C
6		2X 8 THRU	$\oplus \parallel 1$ A B C
7		2x 5 THRU; 7,6X90°; M6X1-6H PLUG TAP THRU	$\oplus \parallel 0,3$ A B C

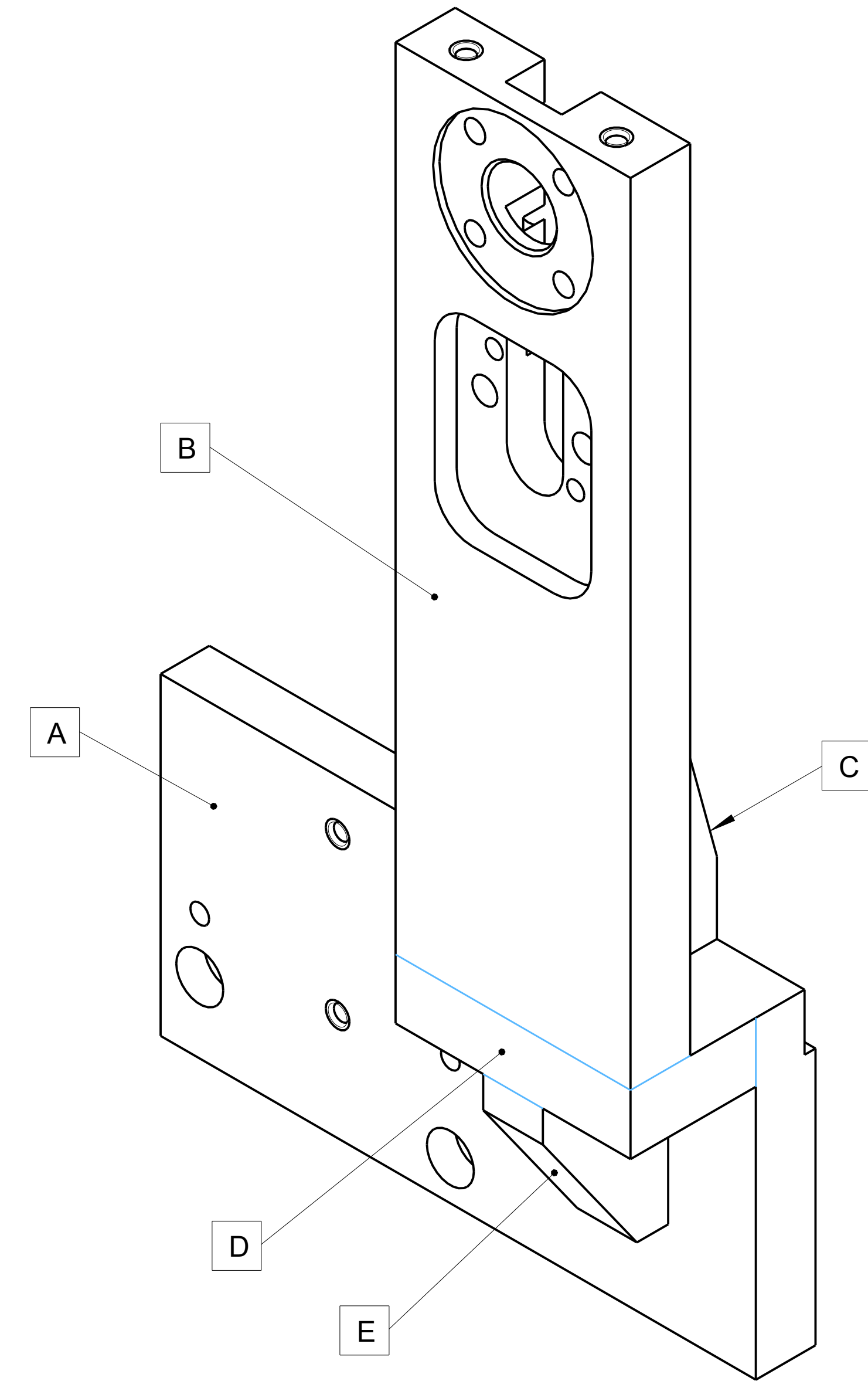
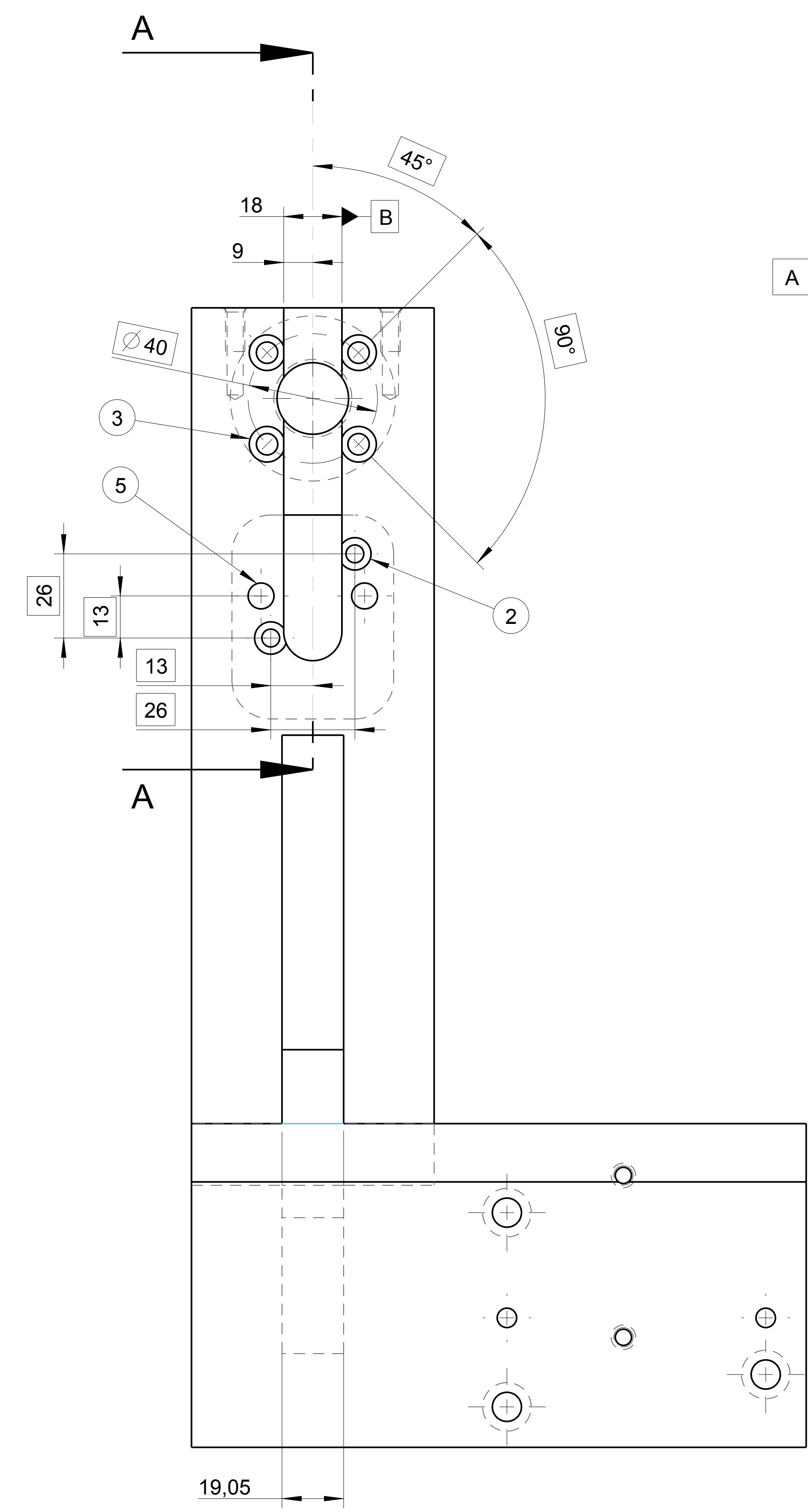
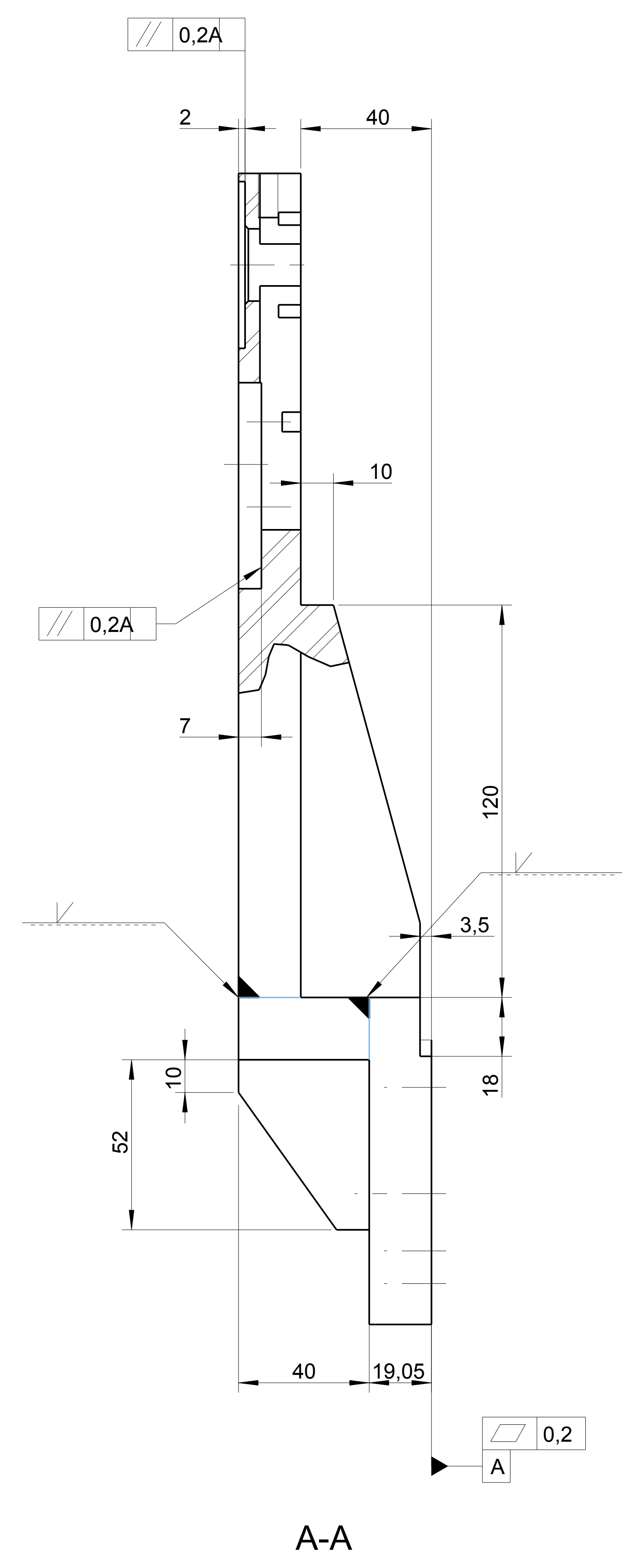
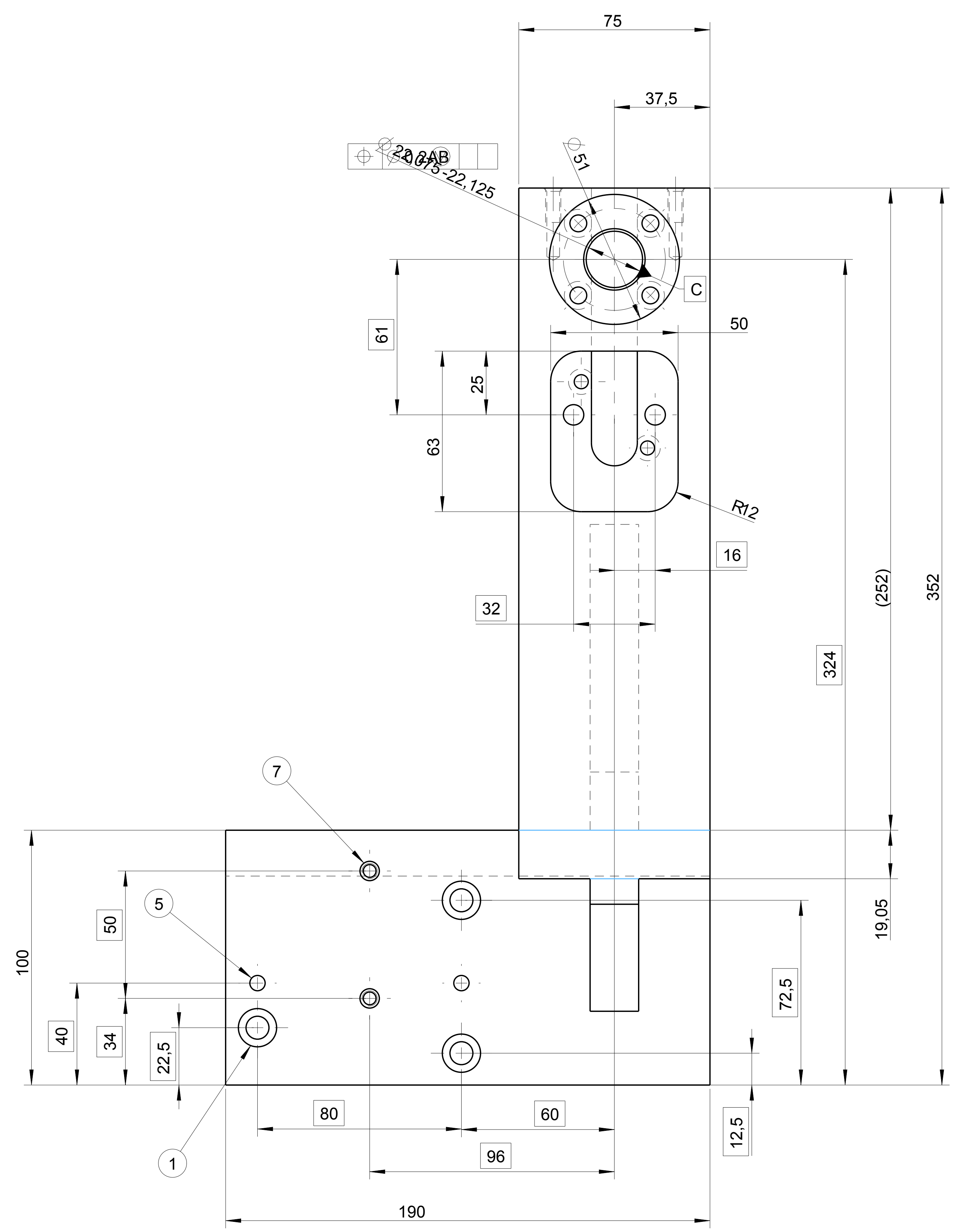

**WELDING NOTES**  
UNLESS OTHERWISE SPECIFIED:  
A. SHIP WELD SIZE EVERY 100 mm, EXCEPT EXTERIOR CORNER WELDS AND LASER REELS WHICH ARE WELDED CONTINUOUS AND DRESSED TO A UNIFORM APPEARANCE.  
B. WELD SIZE TO BE 1X THE THICKNESS OF THE THINNEST MATERIAL.  
C. WELD AND GRIND SMOOTH ALL LOCATING HOLES AND PINS.

**BLACK PENTRATE**

Measure	0.5-8	8-30	30-120	120-400	400-1000	1000-2000	2000-4000	5
Tolerance	±0.1	±0.2	±0.3	±0.6	±1.2	±2.0	±2.0	4
Length	0-10	10-80	80-120	120-400	400+	400+	400+	3
Deviation	±1	±0.30	±0.20	±0.10	±0.15	-	-	2

Material	AS NOTED	Revision	Modification	Date	Modification by	Responsible
Werkstoff	AS NOTED	0		8/1/10	P. WOERNER	D. DELANEY

Heat Treat Address	STRESS RELIEVE	Revision	Modification	Date	Modification by	Responsible
Wärmebehandlung <td>STRESS RELIEVE</td> <td>0</td> <td></td> <td></td> <td></td> <td></td>	STRESS RELIEVE	0				

Part/Stock	ROCHESTER	Supplier Part	Designation	BRACKET-MOUNTING-STEADYREST
		Machine	210H	Designation

Format	Units	Scale	Sheet	of
FORMED PARTS	mm	1:1	1	1

CAD PROJEKT  
 NOTICE: THIS DRAWING MAY INCLUDE UNPUBLISHED PROPRIETARY INFORMATION AND AS SUCH IS TO BE KEPT CONFIDENTIAL AND NOT TO BE REPRODUCED OR USED IN ANY MANNER WITHOUT THE WRITTEN PERMISSION OF THE COMPANY. THIS DRAWING IS THE PROPERTY OF THE COMPANY AND IS TO BE KEPT CONFIDENTIAL AND NOT TO BE REPRODUCED OR USED IN ANY MANNER WITHOUT THE WRITTEN PERMISSION OF THE COMPANY.