

# CREO PARAMETRIC 4.0 *SNEAK PEEK* WHAT'S NEW IN 2D DETAILING

Raphael Nascimento  
Product Manager

13 June, 2016



ptc

A large white number "7" is centered within a white circular outline. The circle is positioned on the left side of the slide, overlapping the white horizontal band.

# 7

# NON-LINEAR CROSS-HATCHING STYLES

# NON-LINEAR CROSS-HATCHING STYLES

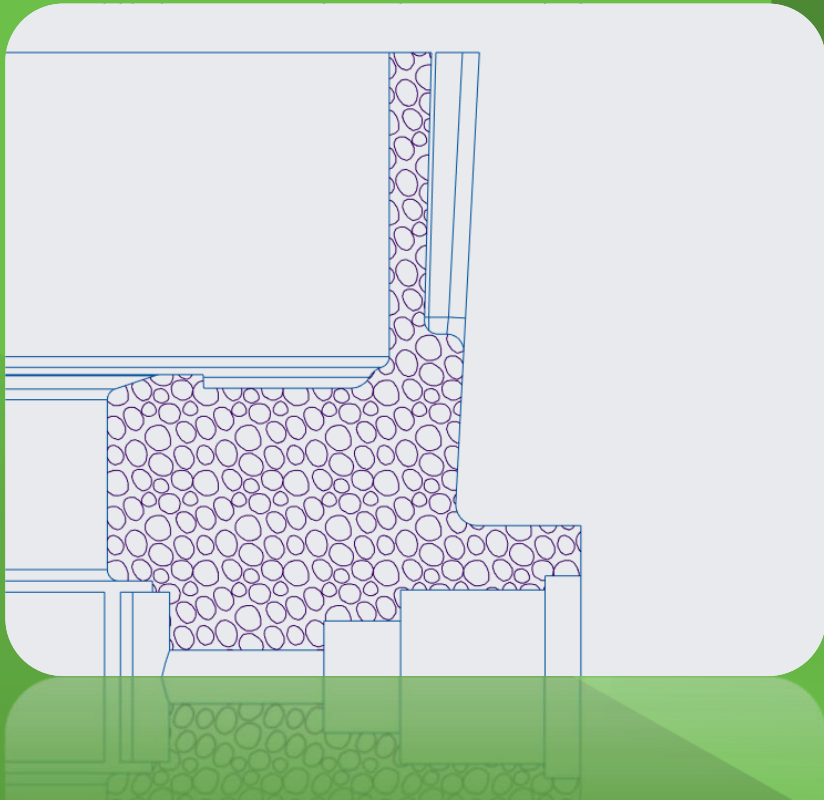

## SUPPORT FOR NON-LINEAR CROSS-HATCH PATTERNS

- Creo now supports industry standard hatch pattern files
  - \*.pat file format
  - Hundreds of patterns available to download from the web
- Selection of common patterns provided OOTB
  - ANSI and ISO standards
  - General patterns
- Control the pattern properties
  - Scale up/down
  - Rotate
  - Color

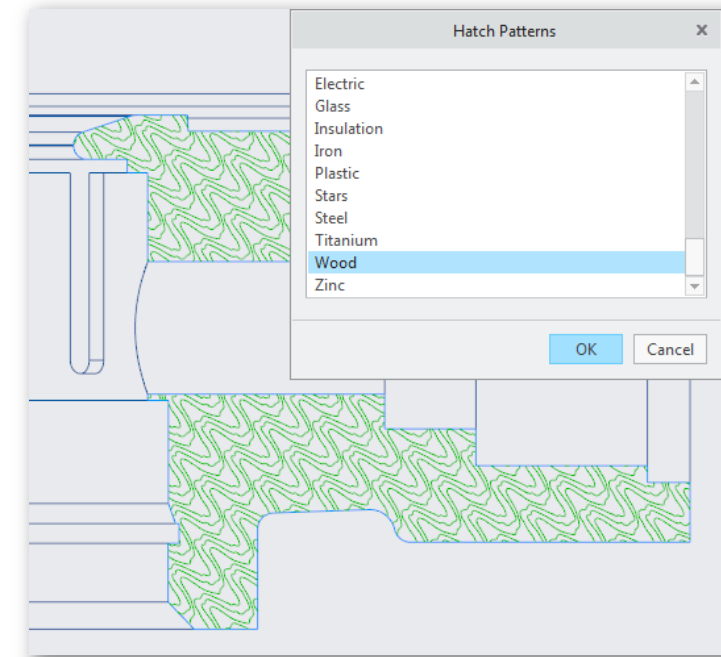



ptc